

GS 2. — 21. travnja 2004.

1. Pomoću utjecajne linije nacrtane primjenom metode sila izračunati $Z(K)$.

$$K = 75 \text{ [kN]}$$

$$EI = \text{const} = 40\,000 \text{ [kN m}^2\text{]}$$

$$I/F = \text{const} = 0,015 \text{ [m}^2\text{]}$$

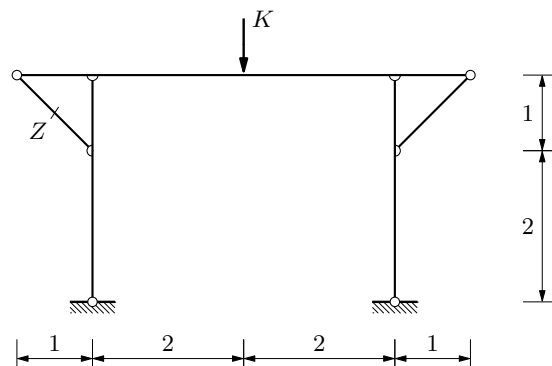

2. Primjenom metode pomaka nacrtati dijagram momenata.

$$H = 120 \text{ [kN]}$$

$$q = 60 \text{ [kN/m}'\text{]}$$

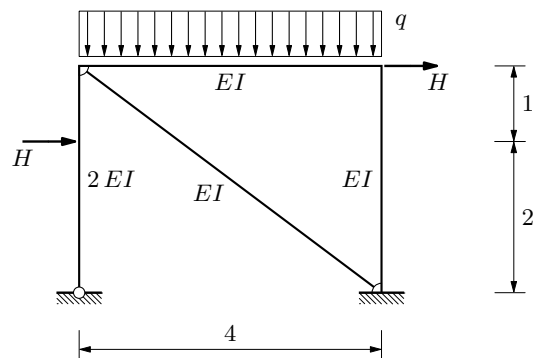

3. Primjenom Crossova postupka nacrtati $\eta_{M_{23}}$ i pomoću nje izračunati $M_{23}(K)$.

