

GS 1. — 2. kolokvij (A) (2005./2006.)

1. (30) Nacrtajte M , T i N dijagrame.

$$M_{\text{lijevo}} = M_{\text{desno}} = 100 \text{ kNm}$$

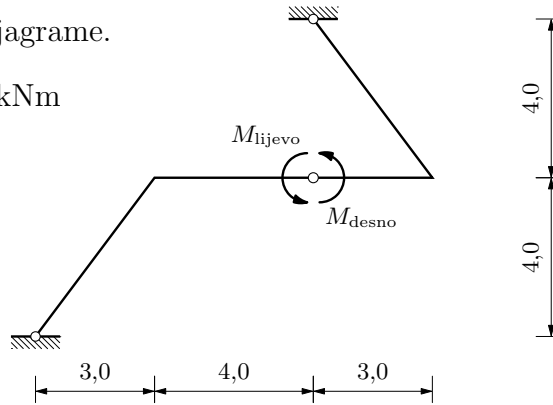

2. (25) Grafičkim postupkom odredite sile u presjeku neposredno ispod hvatišta sile F .

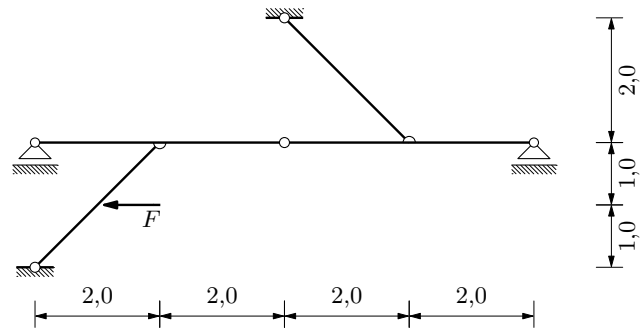

3. (10)

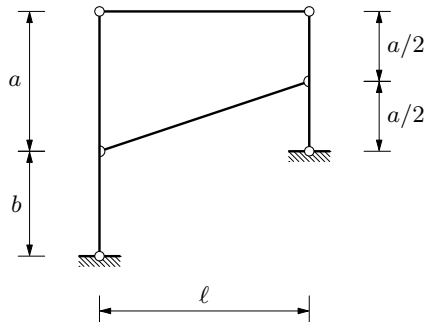

Analizirajte geometrijsku promjenjivost/nepromjenjivost sistema za $b = a$ i $b = a/2$.
(Gornja greda ostaje horizontalna.)

4. (15) Primjenom principa superpozicije nacrtajte M dijagram.

$$M = 75 \text{ kNm}$$

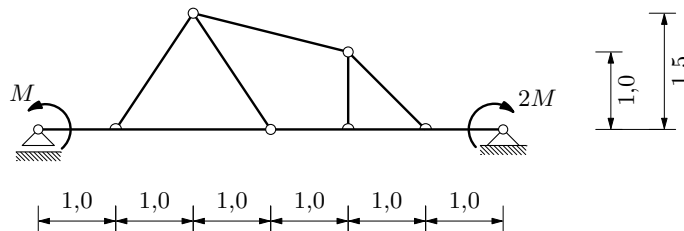

GS 1. — 2. kolokvij (B) (2005./2006.)

1. (25) Grafičkim postupkom odredite sile u presjeku neposredno ispod hvatišta sile F .

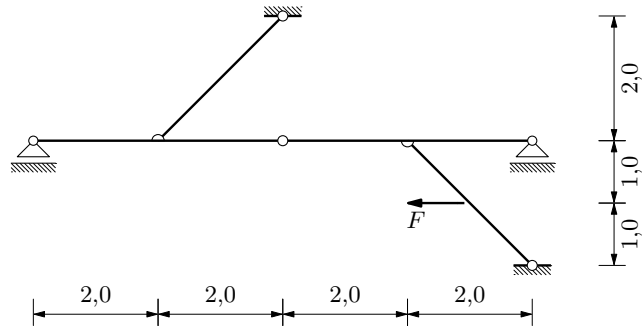

2. (15) Primjenom principa superpozicije nacrtajte M dijagram.

$M = 50 \text{ kNm}$

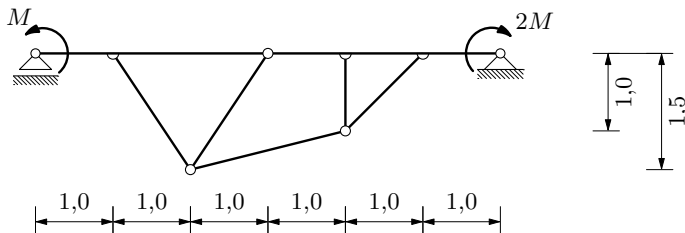

3. (30) Nacrtajte M , T i N dijagrame.

$M = 100 \text{ kNm}$

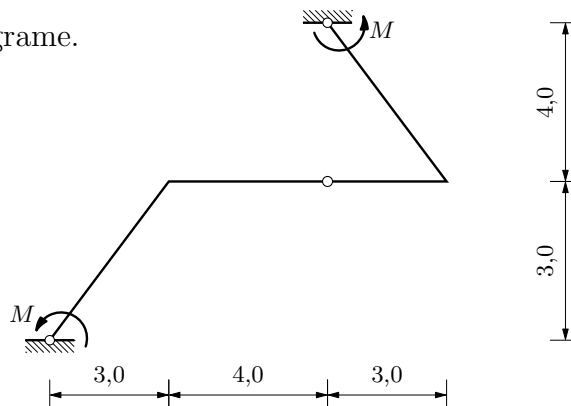

4. (10)

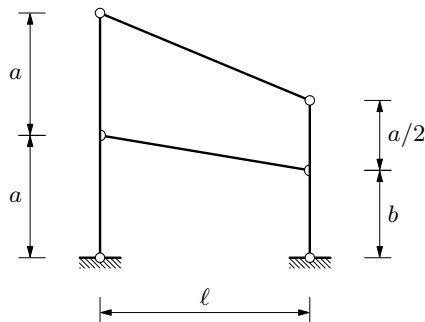

Analizirajte geometrijsku promjenjivost/nepromjenjivost sistema za $b = a$ i $b = a/2$.
(Ležajevi ostaju na istoj visini.)

GS 1. — 2. kolokvij (C) (2005./2006.)

1. (30) Nacrtajte M , T i N dijagrame.

$$F = 125 \text{ kN}$$

$$M_{\text{lijevo}} = 75 \text{ kNm}$$

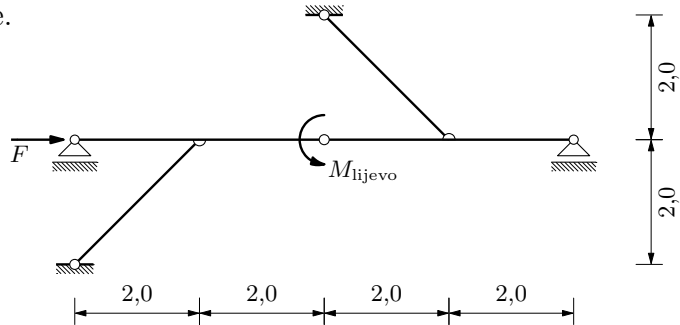

2. (25)

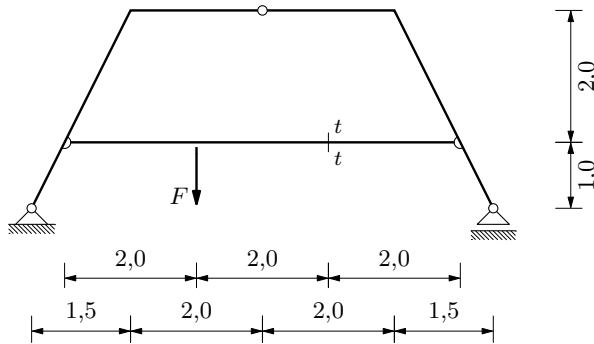

Grafičkim postupkom
odredite sile u presjeku $t - t$.

3. (15) Primjenom principa
superpozicije nacrtajte
 M dijagram.

$$M = 50 \text{ kNm}$$

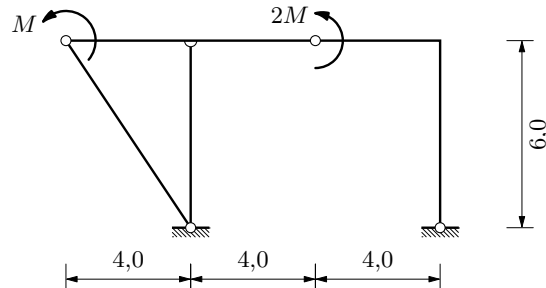

4. (10) Analizirajte geometrijsku
promjenjivost/nepromjenjivost
sistema za $b = a$ i $b = a/2$.

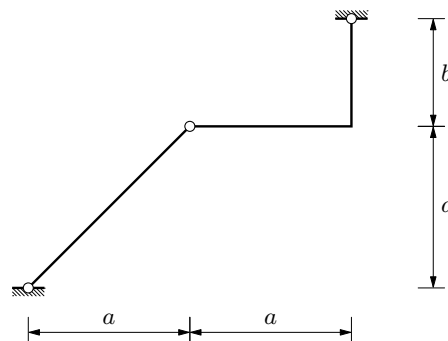

GS 1. — 2. kolokvij (D) (2005./2006.)

1. (25) Grafičkim postupkom odredite sile u presjeku $t-t$.

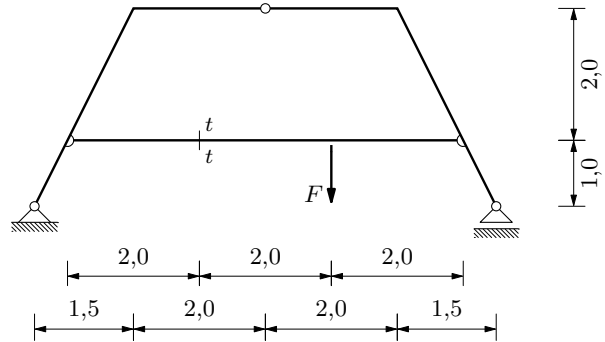

2. (10)

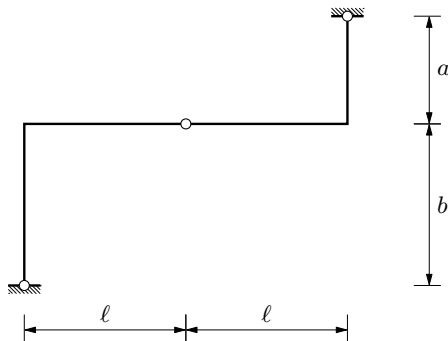

Analizirajte geometrijsku promjenjivost/nepromjenjivost sistema za $b = a$ i $b = 2a$.

3. (30) Nacrtajte M , T i N dijagrame.

$$F = 125 \text{ kN}$$

$$M_{\text{lijevo}} = 75 \text{ kNm}$$

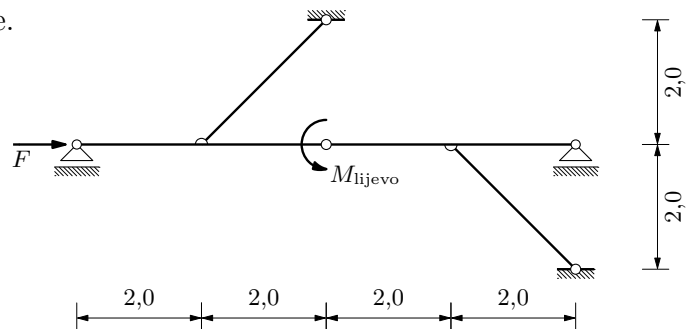

4. (15)

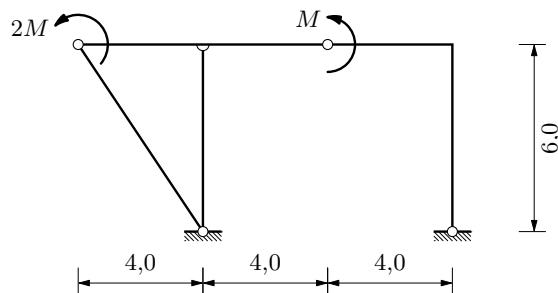

Primjenom principa superpozicije nacrtajte M dijagram.

$$M = 50 \text{ kNm}$$