

GS 1. — 9. veljače 2005.

1. a) Nacrtajte M i T dijagrame.
- b) Pomoću utjecajnih linija izračunajte M_A , M_B , T_B i reakciju D .

$$q_0 = 25 \text{ kN/m'}$$

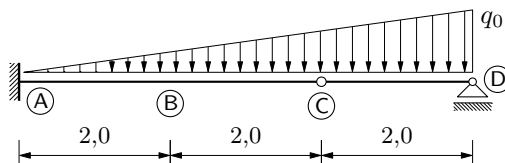

2. Nacrtajte progibnu liniju.

$$M_\ell = 100 \text{ kNm}$$

$$EI = 150\,000 \text{ kNm}^2$$

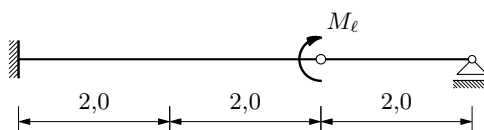

3. Grafoanalitičkim postupkom nacrtajte M dijagram.

$$P = 100 \text{ kN}$$

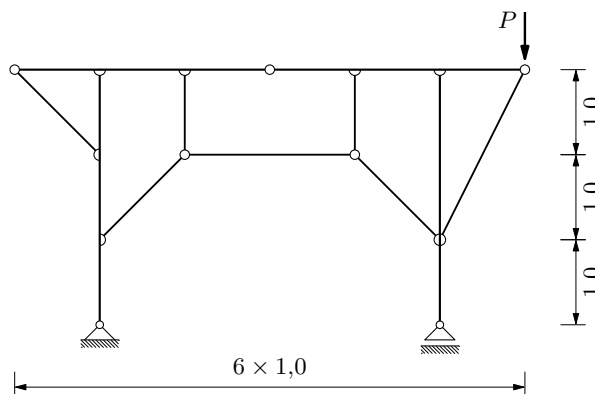

- 4.

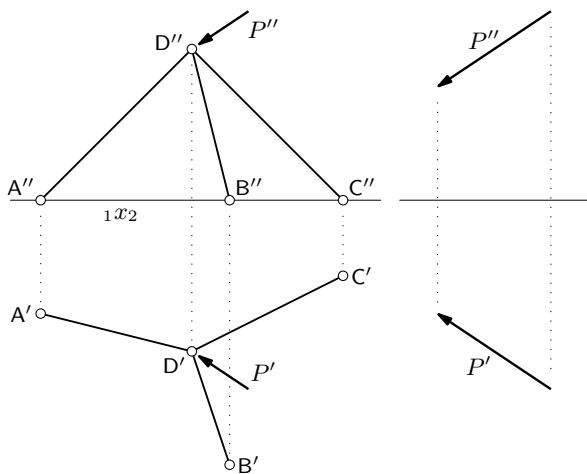

Zadani su tlocrt i nacrt prostorne rešetke (plan položaja) te tlocrt i nacrt sile P (poligon sile).

Čvorovi A, B i C su ležajevi.

Grafičkim postupkom odredite sile u štapovima.

(Zadani plan položaja i poligon sile precrtajte.)